

F Series Connectors



DUPLEX CSA LTD

Contents

	<i>Page</i>
Crimp Connectors	2 - 5
Twist-on Connectors	6 - 7
Bulkhead Connectors	8 - 11
PCB Connectors	12 - 15
Adapters	16 - 17
High Performance	19 - 22

Duplex F Series connectors interface with CATV, MATV and Satellite TV installations and are available in the widest range of configurations.

Electrical Characteristics

Impedance	75 Ohm
Operating frequency	0-3 Ghz
Voltage rating	250 V rms

Materials

Body including fittings	Nickel plated brass
Insulator	Polypropylene
Contact	Phosphor bronze or beryllium copper

Precision Connectors

For applications where electronic performance is more critical, Duplex CSA have developed a range of precision F Series female connectors. These feature:

Return loss	>30db at 3Ghz
Contact	Gold plated, Beryllium copper
Dielectric	Delrin

Currently, standard precision types are the DPX range of connectors (see page 19-22.)

All styles of F Series female connectors can be adapted to precision standards. Talk to us about your requirements.

Waterproof Versions

All F Series female connectors can be supplied in waterproof versions. For waterproof versions of any F Series female connector add the suffix W to the relevant part number.

Custom Connectors

Duplex CSA F Series connectors can be manufactured in a wide range of plating and fixing styles in relatively low quantities. Our range is ever growing to meet customer requirements. For information on your own design of F Series connector contact our sales office.

Fly Lead Assemblies

Duplex CSA are Europe's largest manufacturer of Fly Lead Assemblies. All assemblies are manufactured in the U.K. from piece parts held in stock. This minimises cost and allows fast turnaround of assemblies to customer specifications.

We manufacture cable assemblies of any cable length, colour or type, and terminating with any style of connector. Telephone our sales office to discuss any requirements you may have.

Duplex CSA Ltd

Tel: 00 44 (0)1480 406206

Email: sales@duplexcsa.com

Web: www.duplexcsa.com

Crimp Connectors

**F QUICK MALE, Crimp type
F-101**

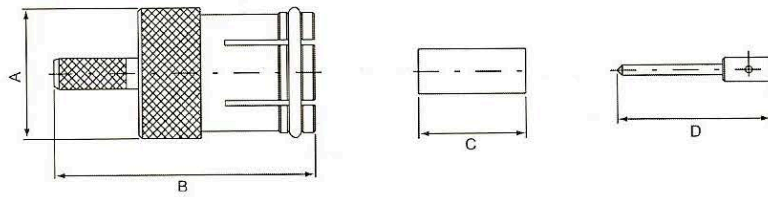

PART NO.	Ω	CABLE TYPE	A	B	C	
F-101A	75	RG6U	11	21	12.7	/
F-101F		RG58U				
F-101G		RG59U				
F-101L	75	RG174U(316U)	11.5	23.2	9.5	

**F QUICK MALE, Attached grip ring
F-104**

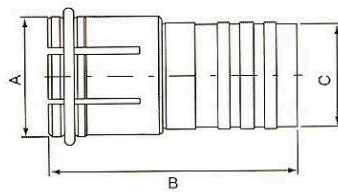

PART NO.	Ω	CABLE TYPE	A	B	C
F-104A	75	RG6U	10.7	22	9.2
F-104F		RG58U	10.8	22	8.5
F-104G		RG59U			

**F MALE, Crimp type
F-111**

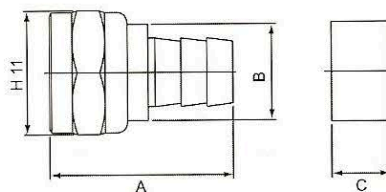

**F MALE, Crimp type
F-111 for RG11U**

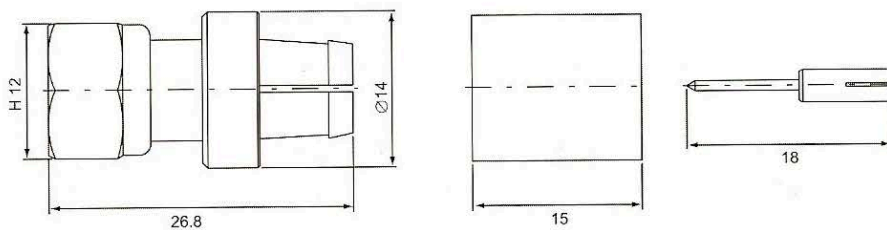

F Series Connectors

F MALE, Crimp type **F-111G-1E for RG59U**

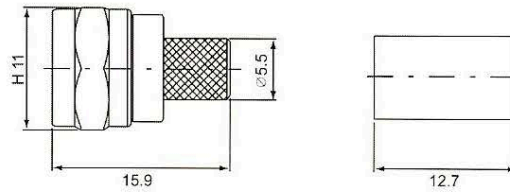

PART NO.	Ω	CABLE TYPE	A	B	C
F-111A	75	RG6U	16	8.5	5
F-111G		RG59U	16.4	8.5	5
F-111G-1			16.4	8.5	12.7

F MALE, Attached grip ring **F-114**

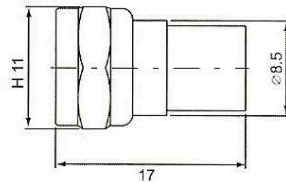

PART NO.	Ω	CABLE TYPE
F-114BA	75	RG6U
F-114BF		RG58U
F-114BG		RG59U

F MALE, Attached grip ring **F-114BB**

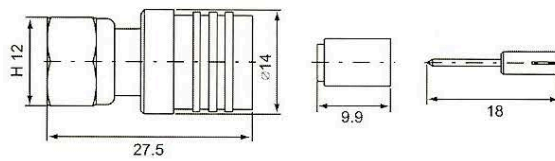

F MALE, Attached grip ring **F-114B**

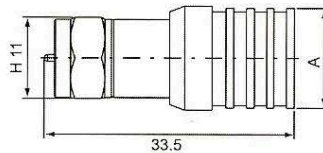

PART NO.	Ω	CABLE TYPE
F-114BA	75	RG6U
F-114BF		RG58U
F-114BG		RG59U

F MALE, Crimp type right angle
F-121

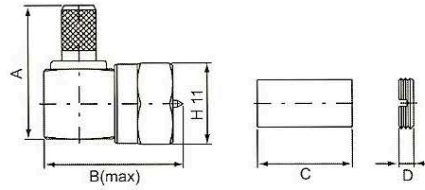

PART NO.	Ω	CABLE TYPE	A	B	C	D
F-121F	75	RG58U	18	18.6	12.7	2
F-121G		RG59U				
F-121L		RG174U(316U)	16.5	18.3	12.7	2

F FEMALE, Crimp type
F-211

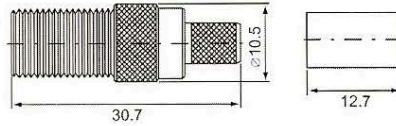

PART NO.	Ω	CABLE TYPE
F-211F	75	RG58U
F-211G		RG59U

F FEMALE, Crimp type
F-211L for RG17U (316U)

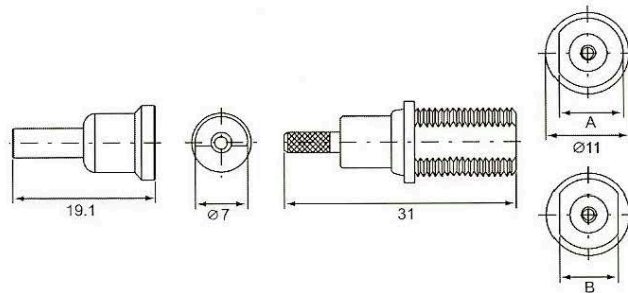

PART NO.	Ω	CABLE TYPE	A	B
F-211A[F,G,L,M,N]-D	75	RG6U[RG58U, RG59U, RG174U(316U), 178U, RG179U]	8.5	/
F-211A[F,G,L,M,N]-D/D			7.7	

F FEMALE, Attached grip ring
F-214

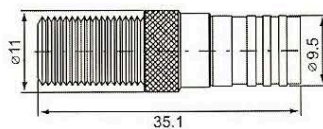

PART NO.	Ω	CABLE TYPE
F-214BA/9.5	75	RG6U
F-214BG/9.5		RG59U

**F FEMALE, Crimp type Bulkhead receptacle
F-231L - 2B - D for RG179U**

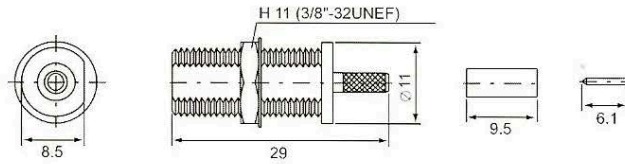

**F MALE, Crimp type
F-411/1**

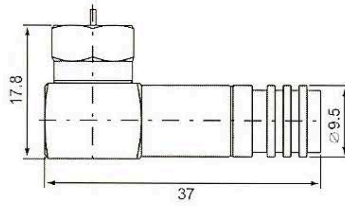

PART NO.	Ω	CABLE TYPE
F- 411A/1	75	RG6U
F- 411F/1		RG58U
F- 411G/1		RG59U

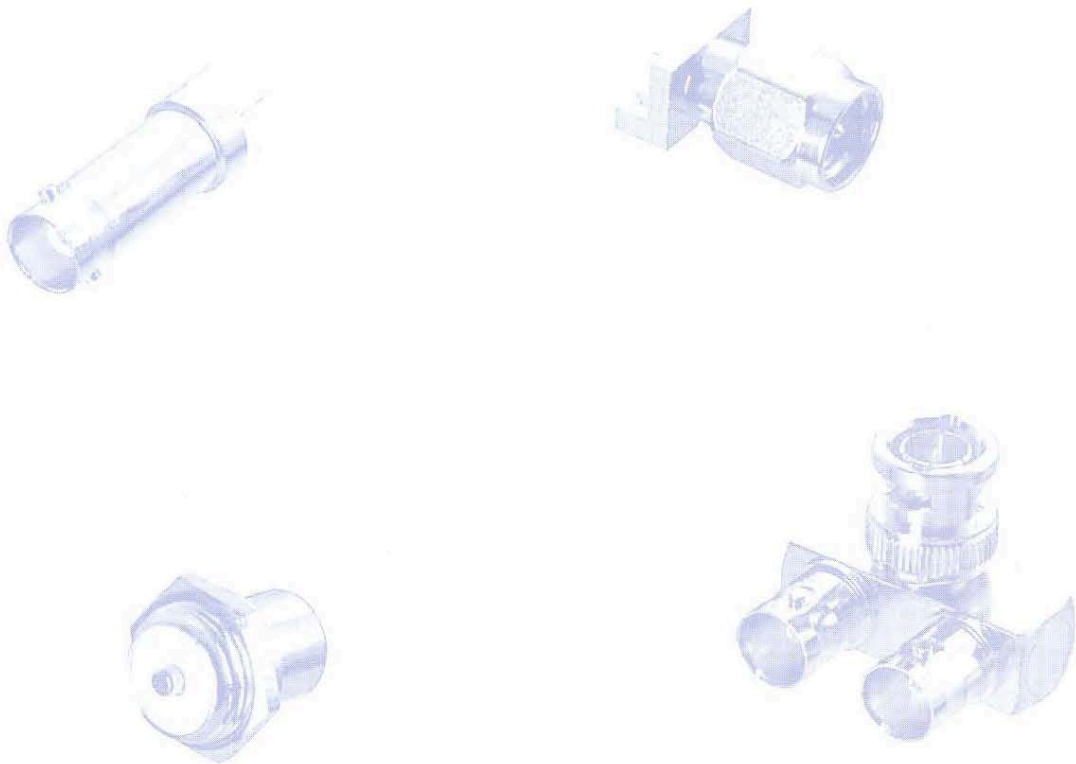

Twist-on Connectors

F QUICK MALE, Twist-on type
F-103

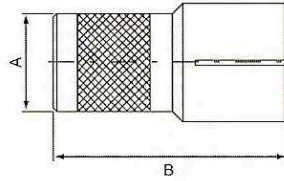

PART NO.	Ω	CABLE TYPE	A	B
F-103A	75	RG6U	8.8	20.5
F-103F		RG58U		
F-103G		RG59U		

F QUICK MALE, Twist-on type
F-103/1

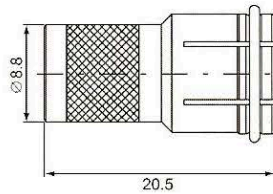

PART NO.	Ω	CABLE TYPE	A	B
F-103/1A	75	RG6U	8.8	20.5
F-103/1F		RG58U		
F-103/1G		RG59U		

F MALE, Screw-on type
F-M112

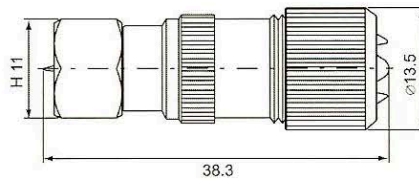

F MALE, Twist-on type
F-113A for RG6U **F-113F for RG58U** **F-113G for RG59U**

F-113A for RG6U

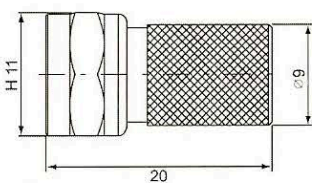

F-113F for RG58U

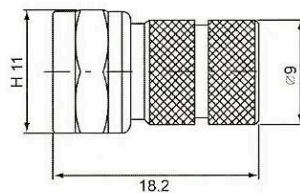

F-113G for RG59U

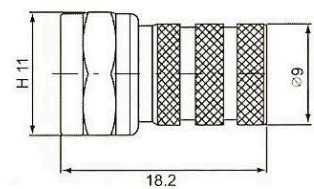

F MALE, Twist-on type
F-L113B / 11U

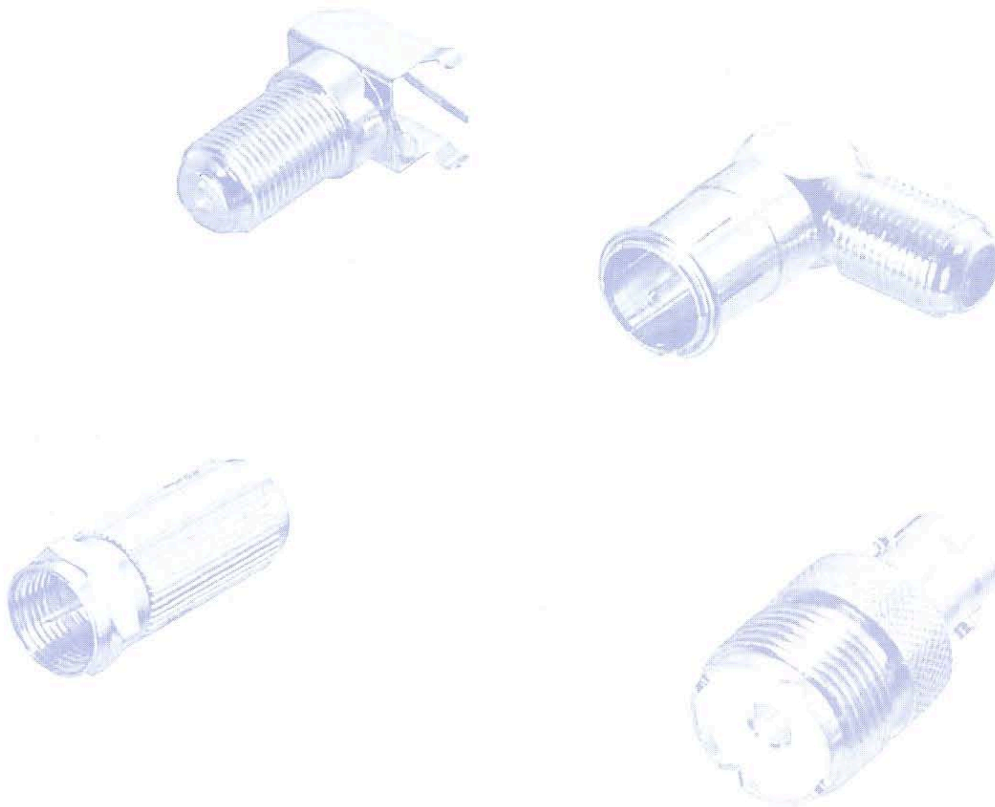
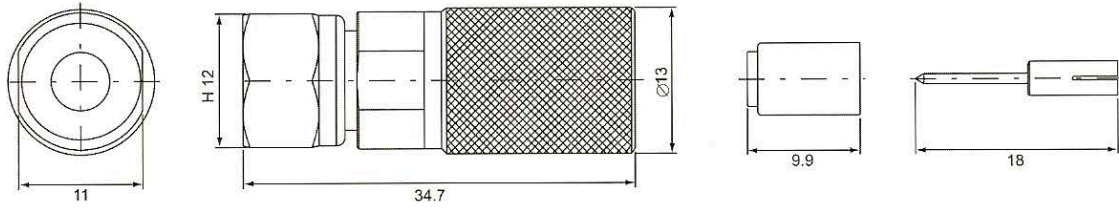

Bulkhead Connectors

**F MALE, Solder type Bulkhead receptacle
F-135**

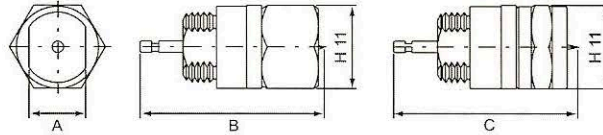

PART NO.	Ω	CABLE TYPE	A	B	C
F-135	75	WELDING SPOT	7.6	24.4	/
F-135-1			7.6	/	24.4
F-135-2			7.4	/	24.4

**F FEMALE, Solder type Bulkhead receptacle
F-235**

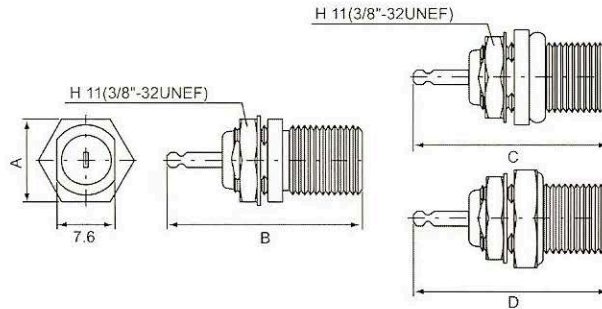

PART NO.	Ω	C	B	C	D	NOTE
F-235	75	11	26.1	/	/	Without NUT&WASHER
F-235NW						With NUT&WASHER
F-235-3B		11	19	/	/	Without NUT&WASHER
F-235NW-3B						With NUT&WASHER
F-235E		11	21.3	/	/	Without NUT&WASHER
F-235-HWP						Without NUT&WASHER
F-235NW-HWP		12.7	/	/	25.8	Without NUT&WASHER
F-235NW-HWP						With NUT&WASHER
F-235HWP(F-61)		13	/	/	/	26
F-235NW-HWP(F-61)	With NUT&WASHER					

**F FEMALE, Solder type
F-B0215-1**

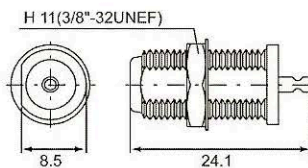

PART NO.	Ω	CABLE TYPE	NOTE
F-B0215-1	75	WELDING SPOT	Without NUT&WASHER
F-B0215NW-1			With NUT&WASHER

**F FEMALE, Solder type
F-B215**

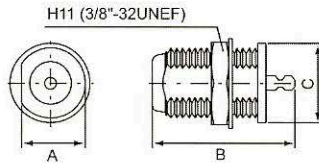

Ps. NW is NUT & WASHER

**F FEMALE, Crimp type Bulkhead receptacle
F-B231-1B-NW**

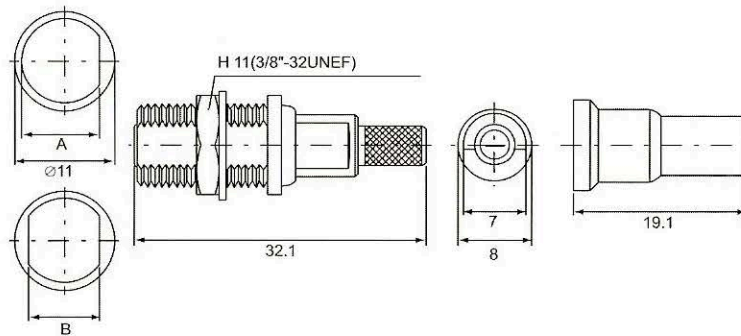

PART NO.	Ω	CABLE TYPE	A	B	C
F-B215	75	WELDING SPOT	8.4	18.5	10.5
F-B215NW					
F-B215/#1			8.4	18.8	10
F-B215/#1NW					
F-B215-1			8.5	19	10.5
F-B215NW-1					

**F FEMALE, Solder type
F-F215
F-F215NW**

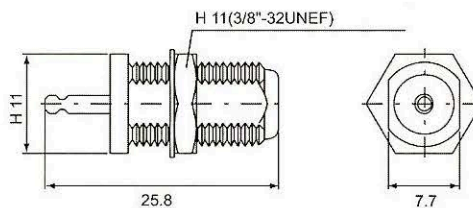

F FEMALE, Solder type
F-S215

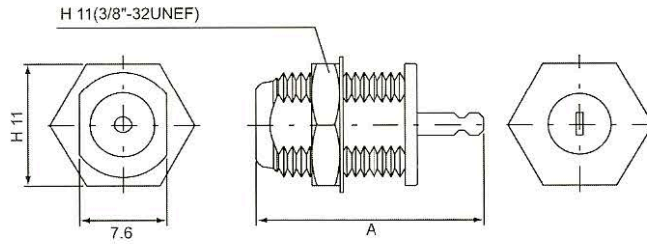

PART NO.	Ω	A
F-S215	75	20.5
F-S215NW		
F-S215-2	75	18.5
F-S215NW-2		

F QUICK MALE, Solder type
F-P105NW-1B

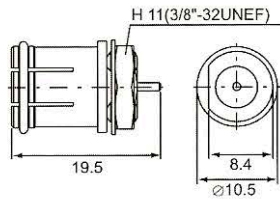

**F MALE, Crimp type Panel receptacle
F-241L - HWP**

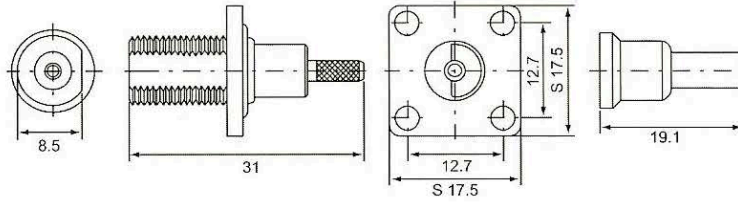

PART NO.	Ω	CABLE TYPE
F-241L-HWP	75	RG174U(316U, 179U, 187U, 188U)

F FEMALE, Solder type Panel receptacle

F-245 - SWP

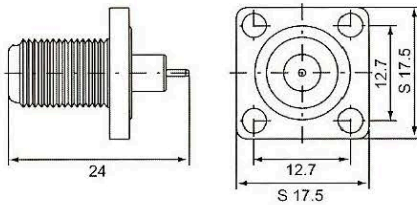

F - 245 - SWP WS

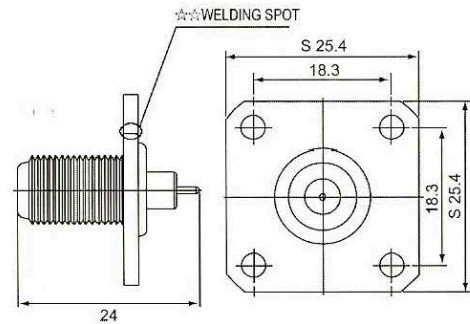

**F FEMALE, Solder type
F-P245 panel receptacle**

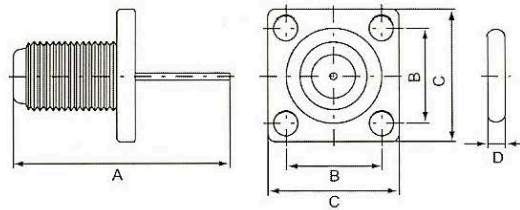

PART NO.	Ω	A	B	C	D
F-P245-25.4	75	31.9	18.3	25.4	
F-P245SWP-1C		28.6	12.7	17.5	1.8
F-P245-2C		31	12.7	17.5	

**F MALE, Solder type Panel receptacle
F-145-SWP**

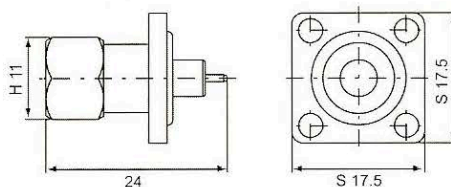

PCB Connectors

F QUICK MALE, Solder type
F-P105-1A PCB mount

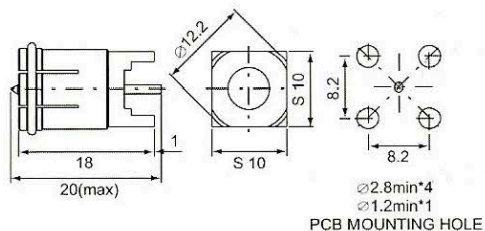

F MALE, Solder type
F-P115H PCB mount

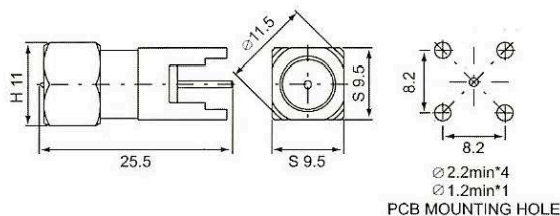

F QUICK MALE, Solder type
F-P125 PCB mount

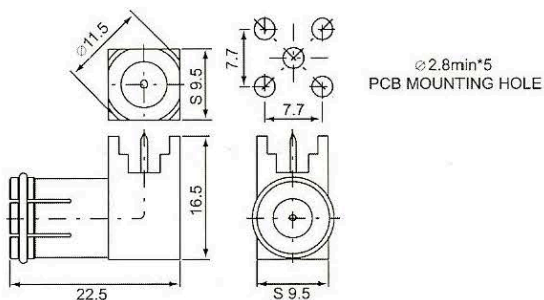

F FEMALE, Solder type
F-P215 PCB mount

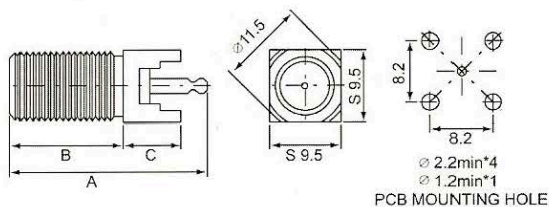

PART NO.	Ω	A	B	C
F-P215H	75	26.2	13	12.5
F-P215L		26.2	15	7.6
F-P215S/1		27.8	20.2	7.6
F-P215SS		22.5	15	7.5
F-P2151		21	13	6.5

F FEMALE, PCB mount

F-P215-1A

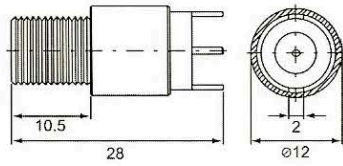

F FEMALE, PCB mount

F-P215H/20

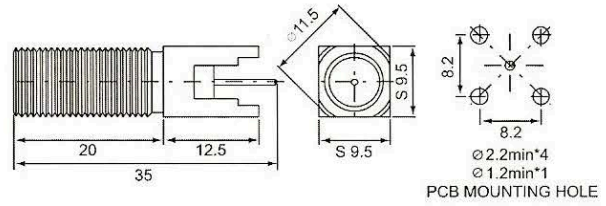

F FEMALE, PCB mount

F-P215L-1A

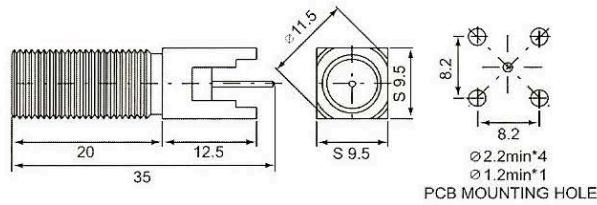

F FEMALE, Solder type

F-P225 PCB mount

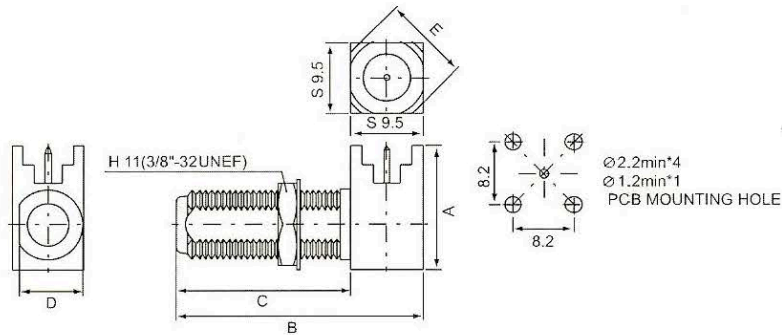

PART NO.	Ω	C	B	C	D	E	NOTE
F-P225	75	16.5	32.5	23	8.5	11.6	Without NUT&WASHER
F-P2255							With NUT&WASHER
F-P225/24		16.5	24	14.5	8.5	11.6	Without NUT&WASHER
F-P225/28							With NUT&WASHER
F-P225NW/28		16.5	28	18.5	8.5	11.8	Without NUT&WASHER
F-P225NW/28-1A							With NUT&WASHER
F-P225/28-1D		16.5	28	18.5	8.5	11.8	Without NUT&WASHER
F-P225NW/28-1D							With NUT&WASHER
F-P225/35.8		14.2	35.8	26.3	8.5	11.6	Without NUT&WASHER
F-P225NW/35.8							With NUT&WASHER
F-P225/36.25		16.5	45.75	36.25	8.5	11.8	Without NUT&WASHER
F-P225NW/36.25							With NUT&WASHER

**F FEMALE, Solder type
F-P225-3A PCB mount**

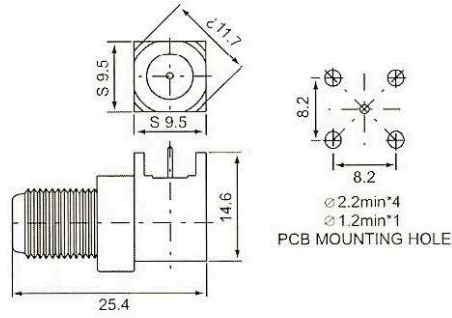

**F FEMALE, Solder type PCB mount
F-P225SH**

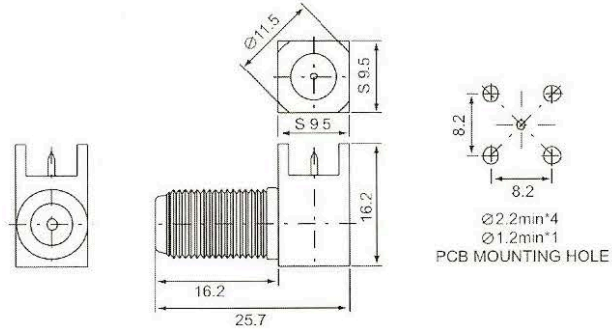

PART NO.	Ω	A	B
F-P225SH	75	25.5	16
F-P225SH/22		22	12.5

**F FEMALE, PCB mount
F-P225SH/22.1**

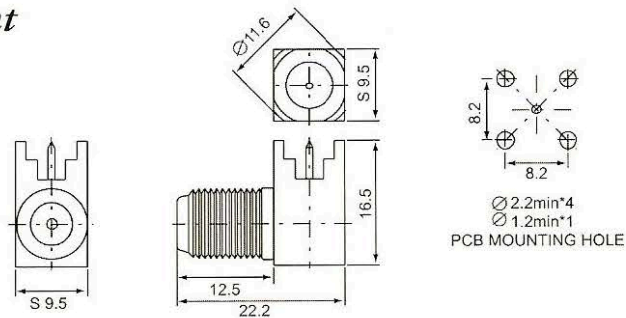

**F FEMALE, PCB mount
F-P2253-1A**

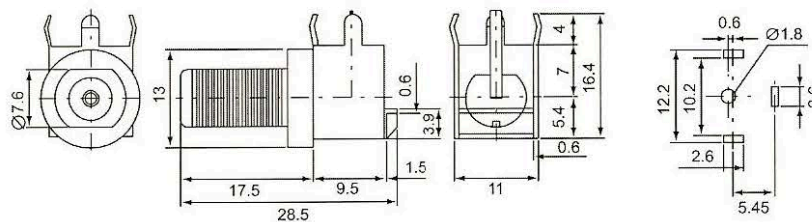

**F FEMALE, PCB mount
F-P2253-2A**

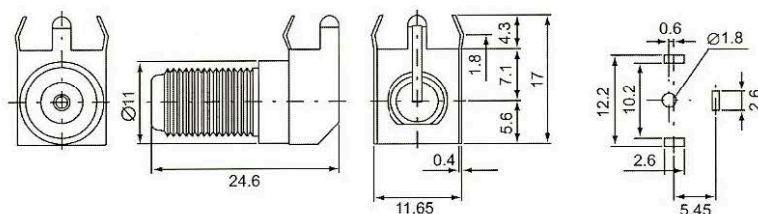

F Series Connectors

F FEMALE, Solder type

F-B215-2B

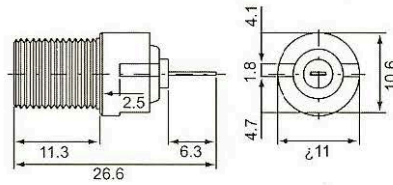

F FEMALE, Solder type

F-B215WP-3B

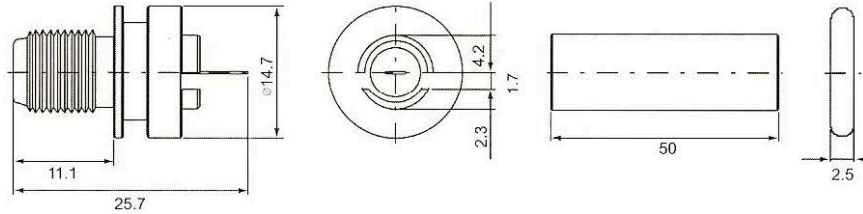

F FEMALE, Solder type

F-B215-4B

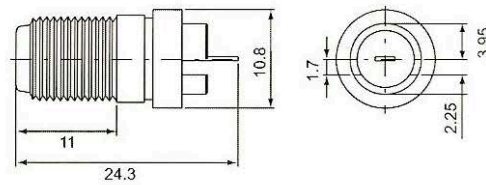

F FEMALE, PCB mount

F-P2215

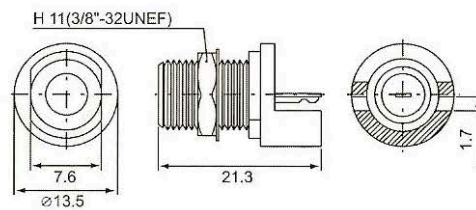

PART NO.	Ω	NOTE
F-P2215	75	Without NUT&WASHER
F-P2215NW		With NUT& WASHER

F FEMALE, PCB mount

F-P2215L

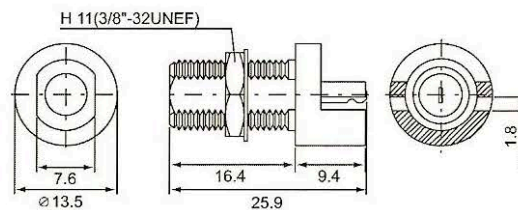

PART NO.	Ω	NOTE
F-P2215L	75	Without NUT&WASHER
F-P2215L-NW		With NUT& WASHER

Adapters

Double F female
F-81K / F-81K-NW (75 Ω)

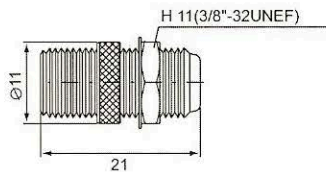

Double F female
F-81K-1 (75 Ω)

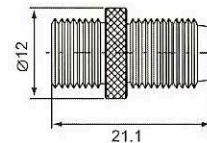

Double F female
F-81L-D-1B (75 Ω)

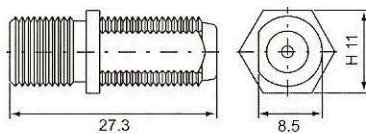

Double F quick male
F-301 (75 Ω)

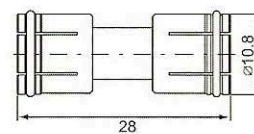

F quick male - F female
F-302 (75 Ω)

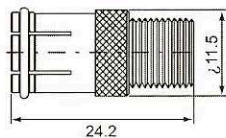

F quick male - F female
F-302-2 / F-302NW-3 (75 Ω)

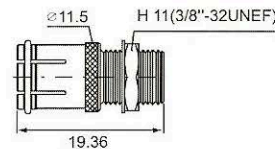

F quick male - F female
F-302 D/D-14 (75 Ω)

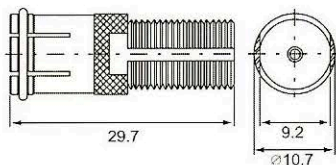

F quick male - double F female L type
F-L302 (75 Ω)

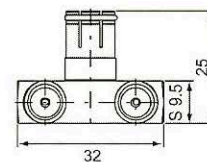

Double F male
F-311 (75 Ω)

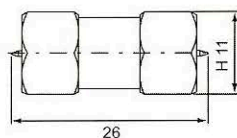

F male - F female
F-312 (75 Ω)

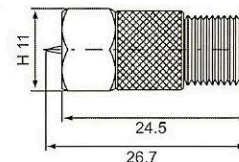

F female Bulkhead receptacle
F-332 (75 Ω)

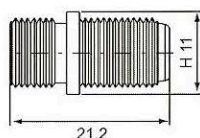

F female Bulkhead receptacle
F-332-1-H11(75 Ω)

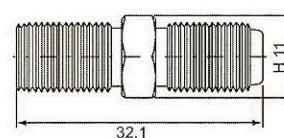

F female Bulkhead receptacle
F-332-27 D/D (75 Ω)

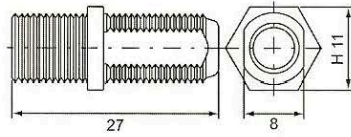

F female Bulkhead receptacle
F-332-24 (75 Ω)

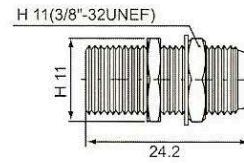

F female Bulkhead receptacle
F-332 D/D-L (75 Ω)

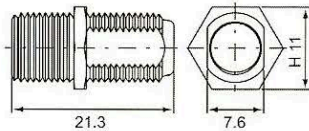

F quick male - F female, right angle
F-402 (75 Ω)

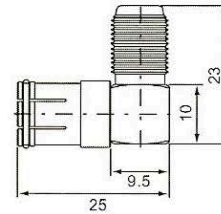

F male-F female right angle
F-412 (75 Ω)

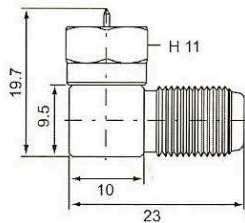

Double F female right angle
F-422(75 Ω)

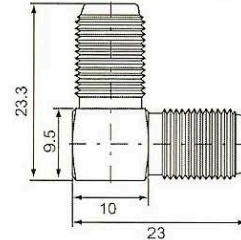

Double F female - single F male, T type
F-512 (75 Ω)

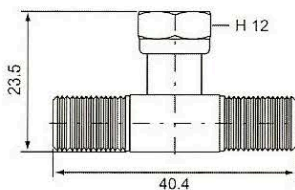

Three F female, T type
F-522 (75 Ω)

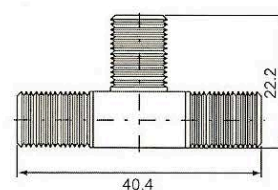

F quick male - BNC female
FB-302 (75 Ω)

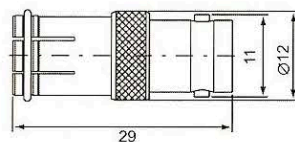

F male - BNC female
FB-312 (75 Ω)

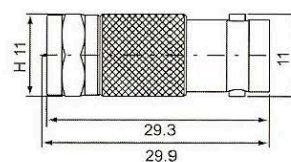

F male - N female
FN-312 (75 Ω)

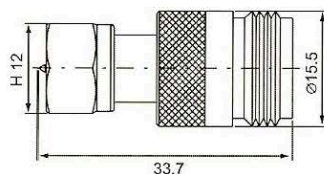

F male - RCA female
FR-312 (75 Ω)

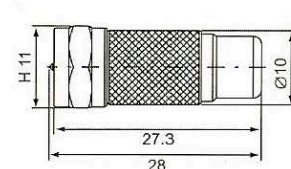

F male - TNC female
FT-312 (75Ω)

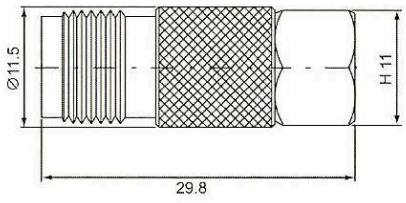

F male - UHF female
FU-312 (75Ω)

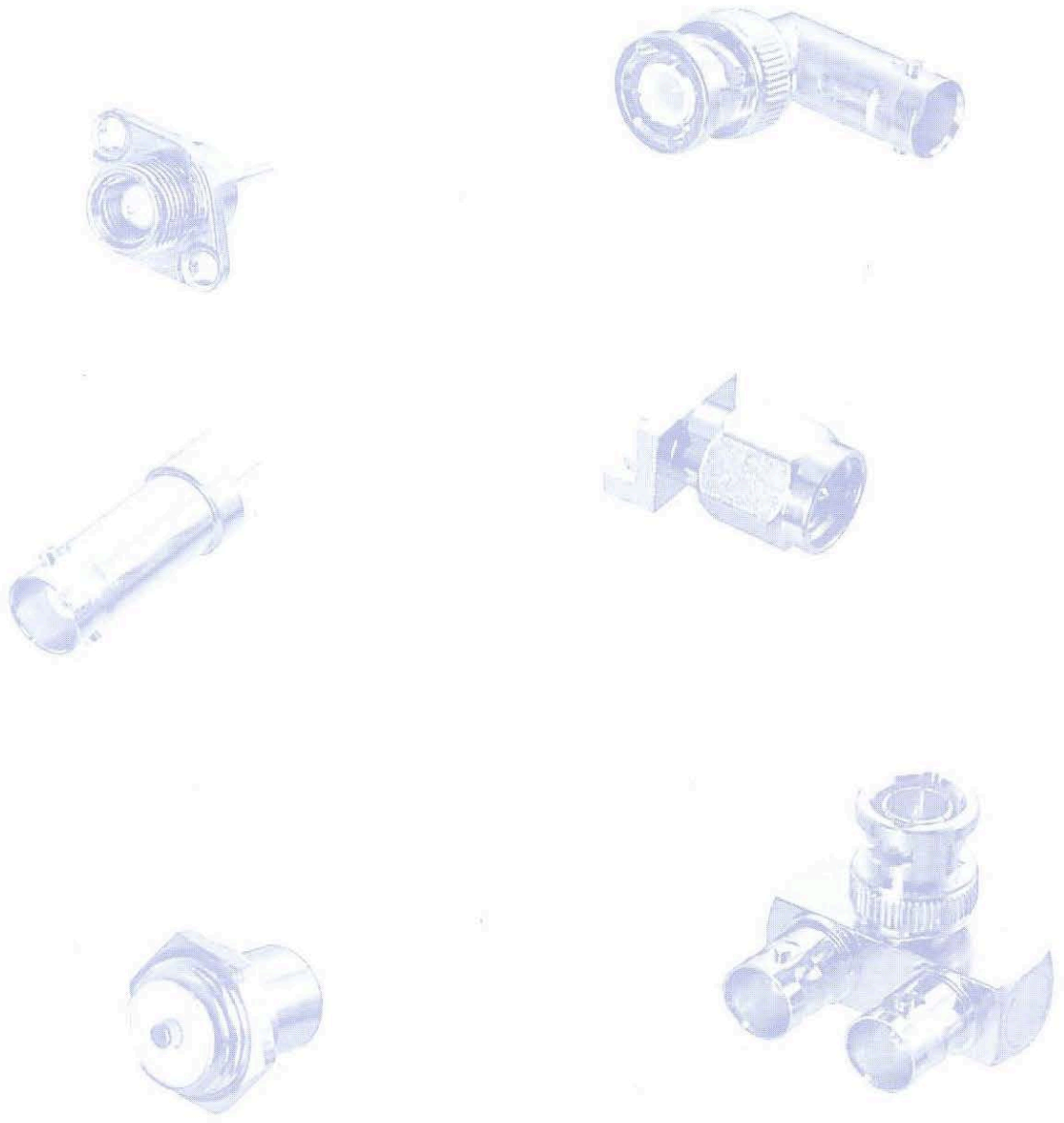
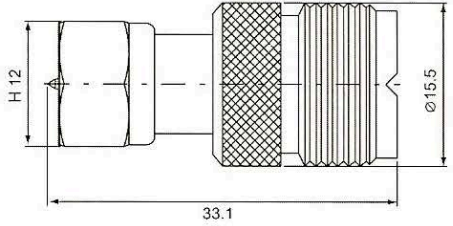

High Performance



F Series Female DPX Connectors

Exceptional performance - standard price

The DPX range of connectors has been designed to produce exceptional return loss performance at a highly competitive cost. Available in F series female, TV male and TV female variants, connectors can be supplied in all mounting types, (pcb mount, bulkhead mount etc.)

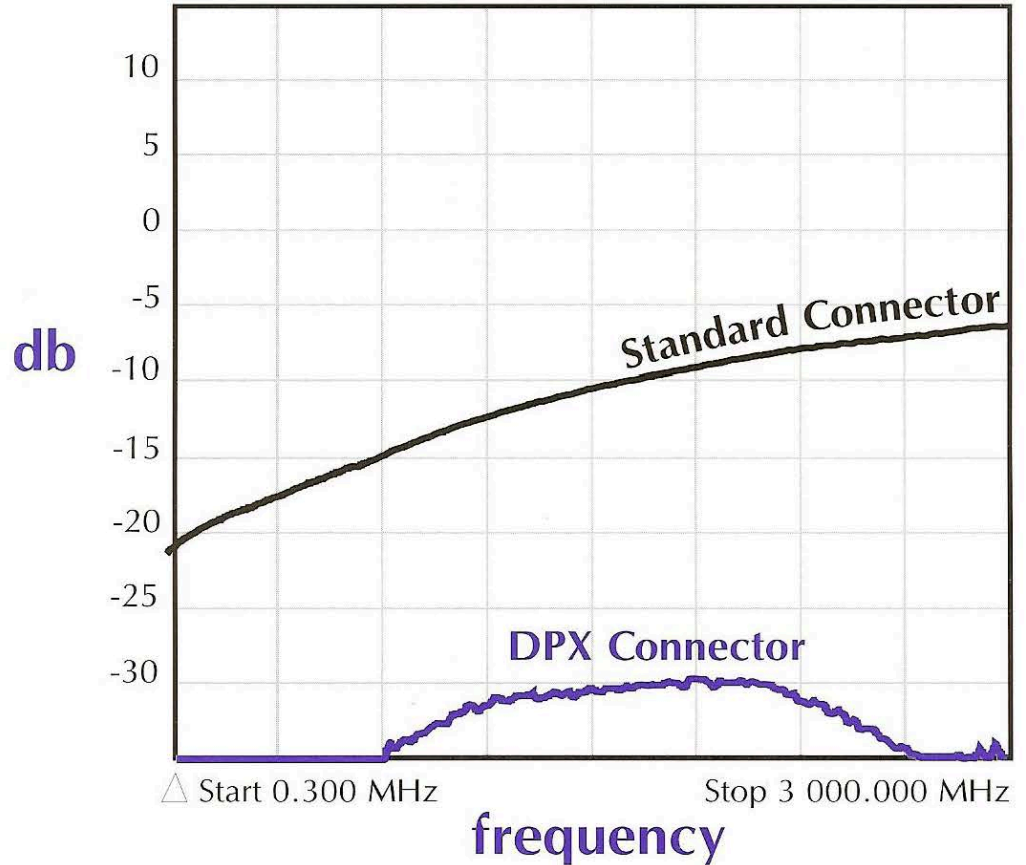

Return Loss Figures

Frequency	F Female	TV Female	TV Male
80 Mhz	> 35 db		
470 Mhz	> 32 db	> 32 db	> 31 db
900 Mhz	> 32 db	> 28 db	> 27 db
2.15 Ghz	> 30 db	> 23 db	> 22 db
3.0 Ghz	> 30 db	> 23 db	> 22 db

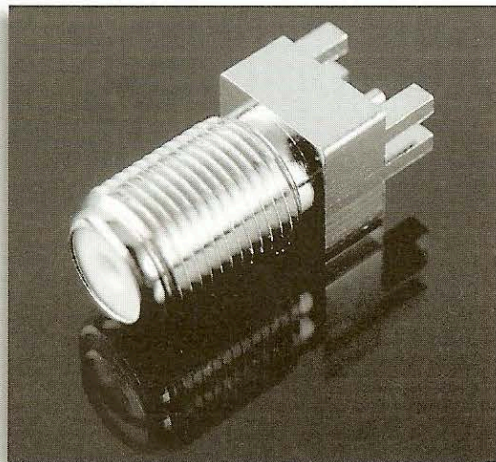

75 ohm 1 - 2Ghz

F FEMALE, Right angle, PCB mount
F-P225 - DPX

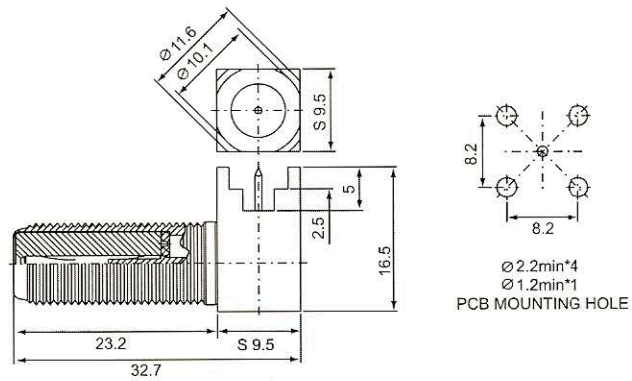

F FEMALE, Right angle, PCB mount
F-P225G D/D - DPX

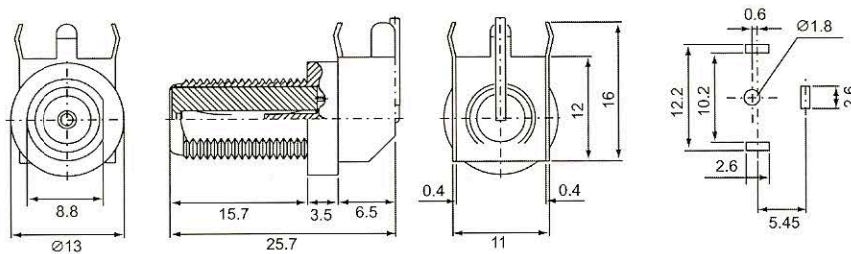

F FEMALE, Solder type panel receptacle
F-P245SWP-1C-DPX

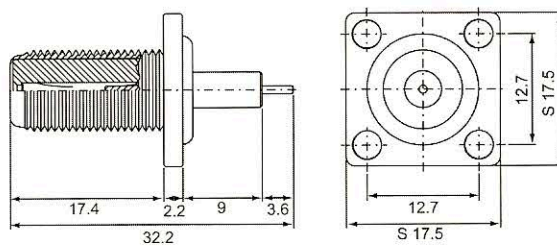

F FEMALE, PCB mount
EMIT-01-DPX (75Ω)

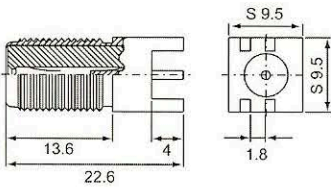

F FEMALE
PG11-F-DPX-17 (75Ω)

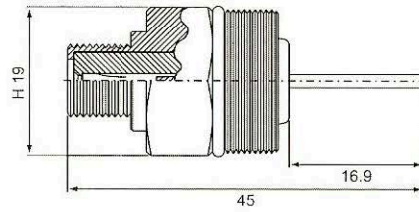

F FEMALE, PCB mount
TRX-08-DPX (75Ω)

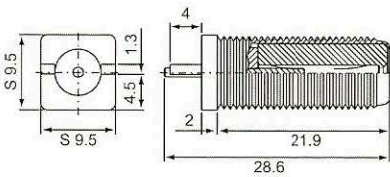

F FEMALE, Solder type
Bulkhead receptacle

F-235-DPX
(75Ω)

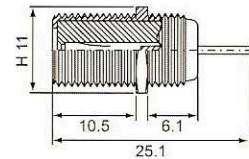

F FEMALE,
Solder type Bulkhead receptacle

F-235-HWP-DPX

(75Ω)

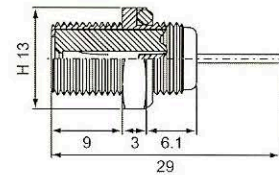

F FEMALE,
Solder type Bulkhead receptacle

F-235W-DPX-HO

(75Ω)

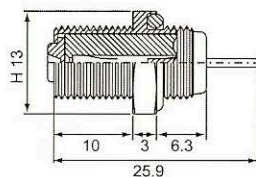

Double F FEMALE, Screw-on
Bulkhead receptacle

F-332W-DPX

(75Ω)

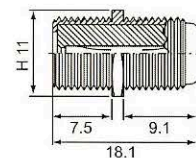

Double F FEMALE, Screw-on
Bulkhead receptacle

F-332-DPXA

(75Ω)

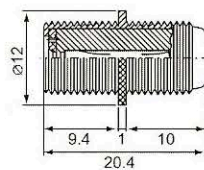

Double F FEMALE, Screw-on
Bulkhead receptacle

F-332-DPXA1

(75Ω)

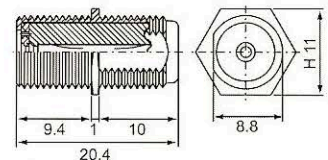

Double F FEMALE, Screw-on
Bulkhead receptacle

F-332H-LD-DPX (75Ω)

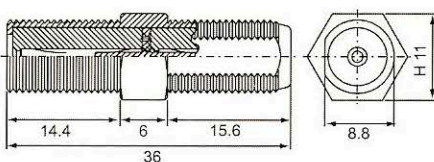

Double F FEMALE, Screw-on
Bulkhead receptacle

F-332D-DPX

(75Ω)

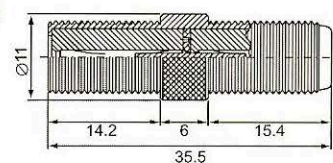

Double F FEMALE Screw-on Bulkhead receptacle
F332LD-DPX
 (75 Ω)

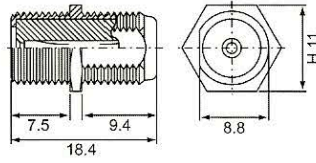

BNC MALE-F FEMALE
BF-312-DPX
 (75 Ω)

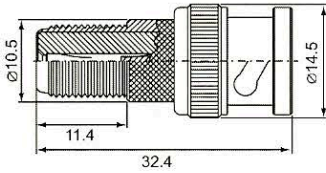

N MALE - F FEMALE
NF-312-DPX
 (75 Ω)

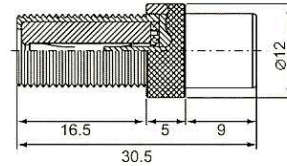

TV MALE-F FEMALE
EF-322-DPX-12
 (75 Ω)

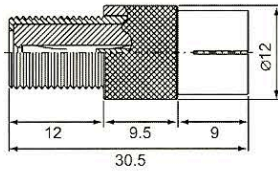

TV MALE-F FEMALE
EF-312-DPX-16
 (75 Ω)

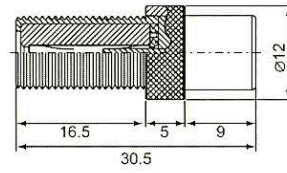

TV FEMALE-F FEMALE
EF-322-DPX-12
 (75 Ω)

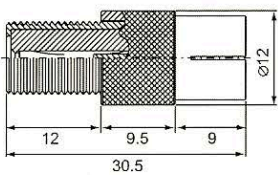

TV FEMALE-F FEMALE
EF-322-DPX-16
 (75 Ω)

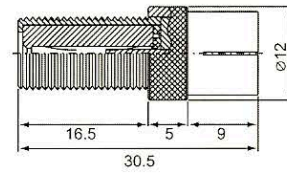

Cable Groups

To denote the cable group required add the following suffix to your part no. (E.g. N Series Male Crimp Type for RG/59 Cable = N - 111G)

Suffix	Cable Type - RG / U
A	5.5A, 6.6A, 212, 222
B	8.8A, 213
C	9.9A, 9B, 214
D	11, 11A
E	22A, 22B
F	58, 58A, 58C, 141, 141A
G	59, 59A, 59B, 62
H	2A, 62B, 62C, 210
J	71, 71A, 71B
K	108A
L	55, 55B, 142B, 400
M	174, 179A, 187, 188, 188A, 316
N	178, 178A, 179B, 196, 196A
P	179B, 187A
Q	55A, 142, 142A, 223
R	BELDEN 8281 BELDEN 8227 and 9207

PCB Board Drillings

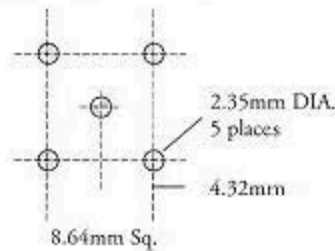

Accessories



Part No. F-N
3/8 32 unf



Part No. F-W
Washer

For further information contact us now:

Tel: 00 44 (0)1480 406206

Email: sales@duplexcsa.com

www.duplexcsa.com